

SHADE ELEMENTS

Interiors

Follow this guide to measure your windows for our Venetian blinds

You will need

- A tape measure that reads in millimetres, long enough to reach across your entire window
- A way to record your measurements - pen & paper

Things to consider

- An inside fit requires a window recess deep enough and gaps around the blind for free movement. Fit your blind inside the window frame for a clean look.
- An outside fit is best for blocking light and insulation. Fit your blind to the outside of the window frame or to the wall just above the window frame for reduced light gaps.
- Inside and outside fitting blinds will have small gaps at the sides, top and bottom of the window.
- Make sure nothing is in the way of where the blind will hang so you can open and close them fully.

Outside Fit

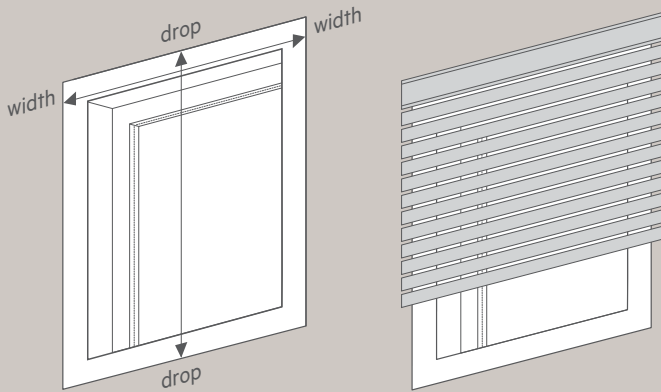

Width

For venetians, fix onto the architrave or the reveal of the window frame, at the top of your window. Measure from the outer edge of the frame on one side to the outer edge on the other, and record this as your width.

Drop

Take your measurement vertically down middle of the window. Measure from the top of the outer edge of the window frame down to the sill, bottom of the window frame or lower if you wish and there is nothing obstructing the blind below. Record the measurement as your drop.

Tip: If fixing the blind above a window frame that is not flush with the wall, you may need to pack out the bracket enough to allow the blind to clear the window reveal when installed.

Inside Fit

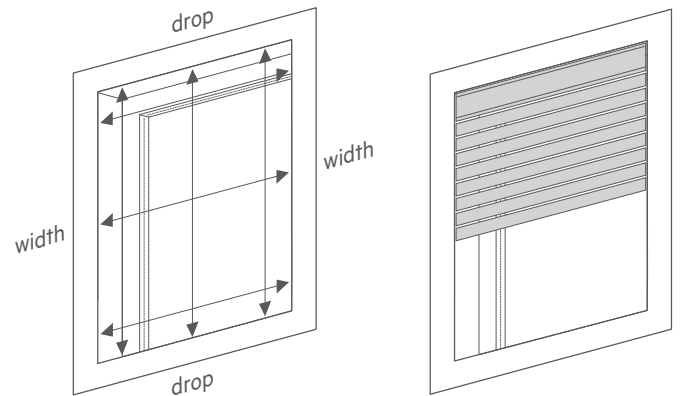

Depth

This measurement is to ensure your blind will fit within the window recess. Measure inside the frame from the front to the first obstruction, eg. glass, latch, handle or mullion. Here's a guide of how much clearance is needed:

- Aluminium venetian - 40mm
- Wood or PVC venetian - 80mm (includes fascia)

Width

Take your measurement horizontally across the window at the top middle & bottom. Measure inside the frame, from frame to frame, not only the panes of glass. Record the smallest measurement as your width.

Drop

Take your measurement vertically down the left, middle & right of the window. Measure inside the frame, from frame to frame, not only the panes of glass. Record the smallest measurement as your drop.

Measuring for controls

Looking at your window, work out which side will be the most convenient to operate the blind from and how long you would like the cord length would be. If the window is high up, a longer cord will hang lower and be easier to reach, while for full length windows a shorter cord may be suitable and out of reach of children. Generally, the cord length is made at 75% of the drop of your blind.

Venetians blinds operate with either a cord to lower and raise and a wand to tilt the slats; or a series of cords to do both.

SHADE ELEMENTS

Interiors

Follow this guide to install your 25mm Venetian blinds

Getting started

Tools required;

- Pencil
- Tape measure
- Electric screwdriver
- #2 square drive

Inside Fit

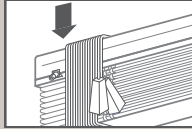
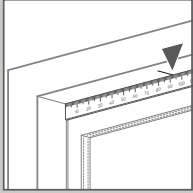

Step 1

On the same side as the control at the inside top of the window frame mark 92mm in with a pencil.

For example, the image above shows a left hand control.

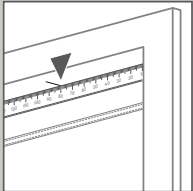

Step 2

On the other side of the window place a mark on the inside of the window frame 80mm in.

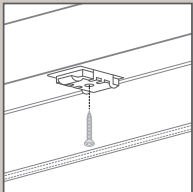

Step 3

Top fix brackets with screws

Fix each bracket to the top side of the window with a single screw, lined up with the marks made in steps 1 and 2.

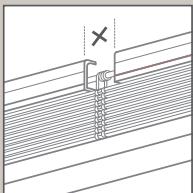

Step 4

With any remaining brackets (supplied if required), space them evenly between the left and right side brackets, being careful they won't interfere with the ladders of the blind when installed.

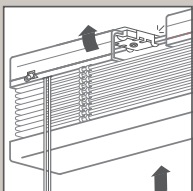

Step 5

Unwind the cords from the control end. Holding the blind closed, align the front of the headrail to the brackets and tilt the base outwards to allow the headrail to 'hook' onto the front of each bracket.

Once the front is hooked, use your thumbs to push the back of the headrail up until you hear it 'click'. Do this at each bracket to ensure the blind is secure.

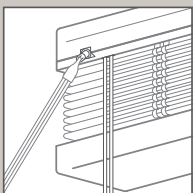

Step 6

1 x hex tilt wand

Attach the hook on the hex wand to the loop on the control end of the blind.

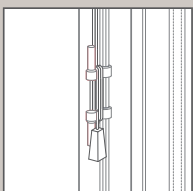

Step 7

1 x cord cleat with screws

Cord cleats are attached to the hex wand to store excess cord when the blind is in the 'up' position.

Being careful not to damage the blind or cords when removing the packaging, unpack the blind and check all parts are included;

- Venetian blind
- Top fixing brackets with 1 x screw per bracket
- 1 x hex tilt wand with cord cleats

Outside Fit

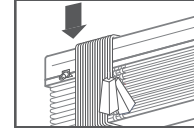
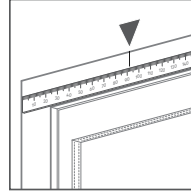

Step 1

On the same side as the control at the inside top of the window frame mark 92mm in with a pencil.

For example, the image above shows a left hand control.

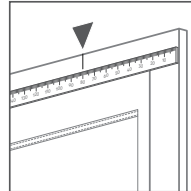

Step 2

On the other side of the window place a mark on the inside of the window frame 80mm in.

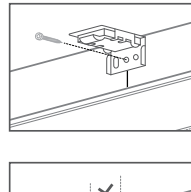

Step 3

Top fix brackets with screws

Fix each bracket to the top side of the window with a single screw, lined up with the marks made in steps 1 and 2.

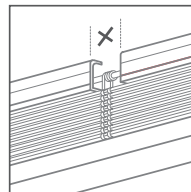

Step 4

With any remaining brackets (supplied if required), space them evenly between the left and right side brackets, being careful they won't interfere with the ladders of the blind when installed.

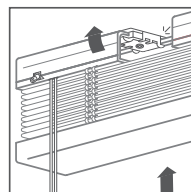

Step 5

Unwind the cords from the control end. Holding the blind closed, align the front of the headrail to the brackets and tilt the base outwards to allow the headrail to 'hook' onto the front of each bracket.

Once the front is hooked, use your thumbs to push the back of the headrail up until you hear it 'click'. Do this at each bracket to ensure the blind is secure.

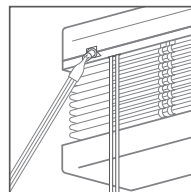

Step 6

1 x hex tilt wand

Attach the hook on the hex wand to the loop on the control end of the blind.

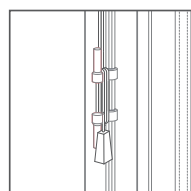

Step 7

1 x cord cleat with screws

Cord cleats are attached to the hex wand to store excess cord when the blind is in the 'up' position.